

BAKOR

**NO DRAFTS.
NO LEAKS.
NO PROBLEM.**

Bakor Blueskin® Weather Barrier Self-Adhesive Membrane
self-seals around nails.



Blueskin® Weather Barrier

SELF-ADHESIVE MEMBRANE

DO IT RIGHT... DO IT ONCE WITH BAKOR

Look to Bakor, with its leading position in self-adhesive bitumen technology,
for solutions in Roofing, Waterproofing and Air Barriers.

www.bakor.com

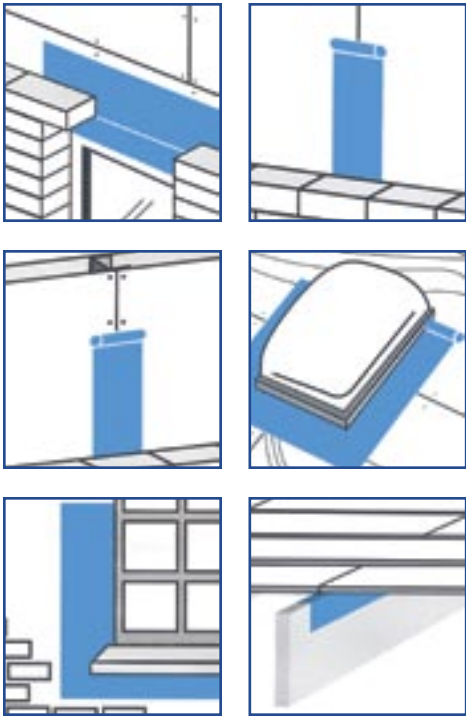

Rough Window (Opening) Flashing Guidelines

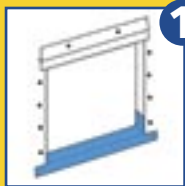

- 1 Make vertical cuts to building paper (wrap), fold up and nail temporarily. Install sill piece first, lapping on to wall and up jamb 75 mm (3").

TIP: Prime all areas with Bakor Aquaprime™ Primer, Bakor Aquatac™ Primer or Bakor Blueskin® Primer Ultra to provide optimum adhesion.

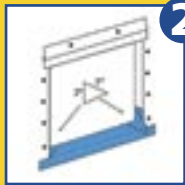

- 2 Apply gussets at corners.



- 3 Install jamb pieces, lapping 75 mm (3") with gussets in top corners.



- 4 Install Bakor Blueskin® Weather Barrier Self-Adhesive Membrane at head. Fold down building paper (wrap) and secure in place. Roll at completion of each step to ensure proper adhesion.

Flanged Window (Exterior) Flashing Guidelines



- 1 Secure flanged window in place. Install membrane to sill portion.

TIP: Prime all areas with Bakor Aquaprime™ Primer, Bakor Aquatac™ Primer or Bakor Blueskin® Primer Ultra to provide optimum adhesion.



- 2 Apply membrane to jambs.



- 3 Complete installation with head piece. Roll at completion of each step to ensure proper adhesion.



- 4 Complete installation by folding building paper (wrap) on to membrane at head and secure in place.