

1. Deck
2. Primer
3. Blueskin® WP 200 Membrane
4. Extruded Polystyrene Insulation (Drainage Type Optional)
5. Geocomposite Drainage Board (Optional)
6. Pavers

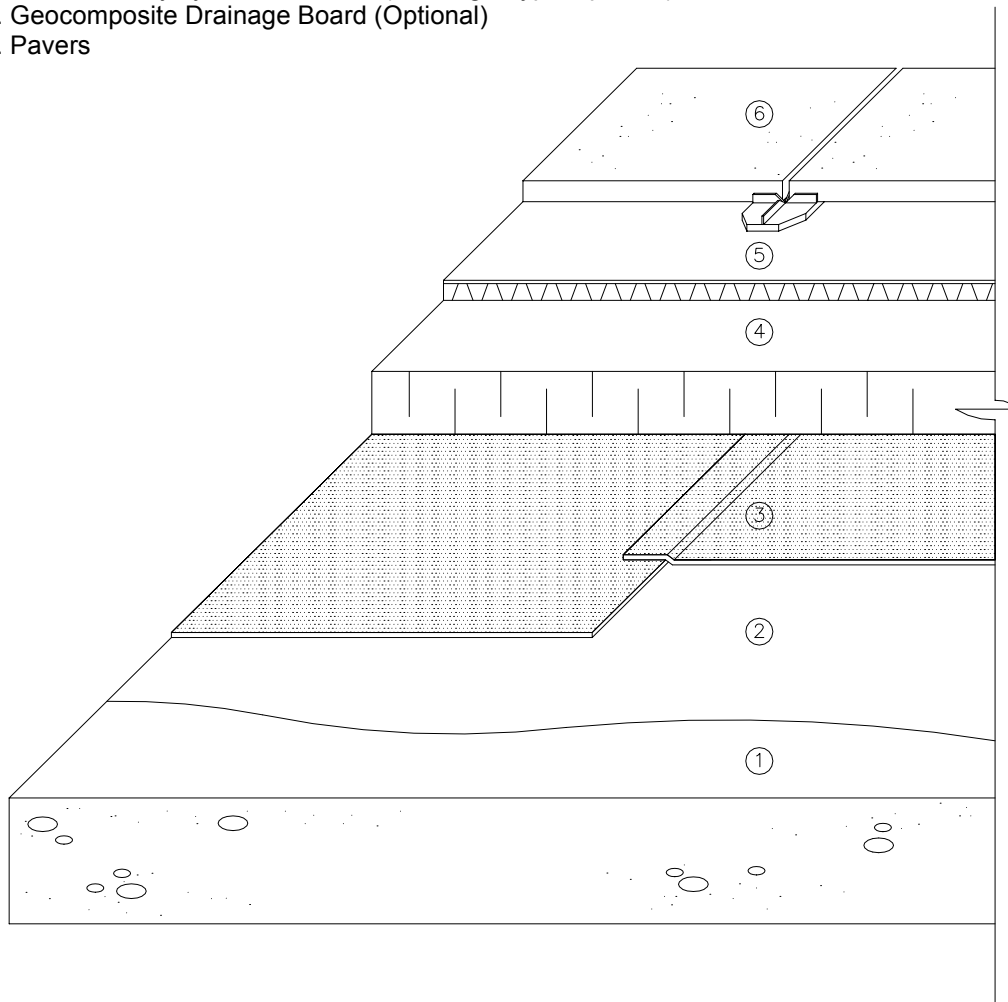

Notes

1. System detail showing typical application to an insulated concrete plaza deck.
2. Application of the Blueskin WP 200 membrane begins at the drain and proceeds toward the high point in a shingle fashion.
3. Other horizontal applications include planters, indoor mechanical rooms, laboratories and bathrooms.
4. Drainage may be facilitated by using drainage type polystyrene insulation. On non-insulated assemblies, a geocomposite drainage board may be used.

Blueskin® WP 200

SYSTEM DETAIL

CONCRETE PLAZA DECK

Scale: N.T.S.

Plot: 1:5

Issued: 02-14-97

Revision: 03

ES-2B98

BAKOR

375 Pendant Drive, Unit #2,
Mississauga, ON L5T 2W9
10 avenue St. Pierre, Lachine, PQ H8R 1N7